

## CONSTRUCTION NOTIFICATION

*Coastal GasLink is committed to creating an extraordinary legacy of safety and respect for all people, communities and the environment. As part of this commitment we are keeping our neighbours along the project route informed on construction activities happening near their community. Please note the following information:*

**What:** As part of Coastal GasLink's construction activity, we will start clearing and construction activities on the Kitimat Meter Station powerline route in mid-March. The powerline route is located between the end of Forest Avenue and the Coastal GasLink Kitimat Meter Station, shown in red on the map below. There may be traffic interruptions for certain equipment moves on Wathl FSR (between Forest Ave and South Hirsch Mainline).

**When:** Beginning as early as March 10, 2021, clearing activities will begin followed by construction activities. It is possible that Wathl FSR and South Hirsch Mainline *may* experience periodic traffic delays occurring daily between 7 a.m. and 7 p.m.

**Where:** Clearing and construction activities will occur within the powerline route with access from Forest Avenue, South Hirsch Mainline and Wathl FSR.

**Expected Duration:** Clearing, construction and access activities are expected to run from March 10 to April 10, 2021.

**Potential Impact:** While there are no anticipated permanent road closures required as part of this activity, there may be brief periods of time when road access will be interrupted for equipment moves. Additional signage and flagging personnel will be present (as required) to help guide traffic for residents and community members.

**Map:** Please see the following page.

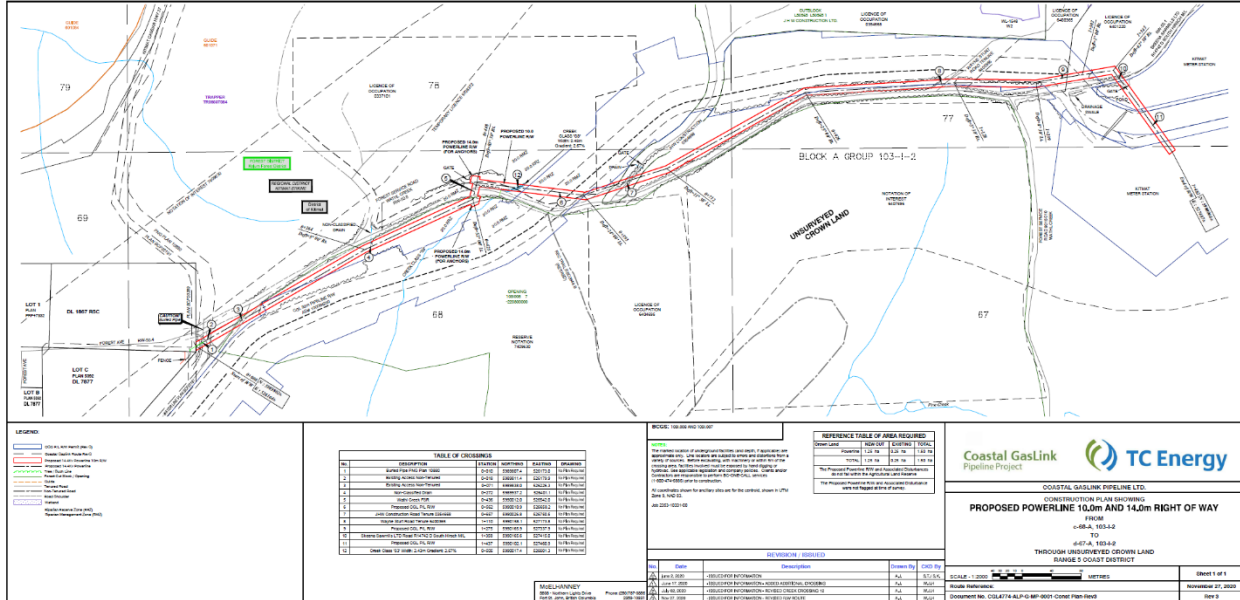

Questions regarding these activities or general project construction can be directed via email to [coastalgaslink@tcenergy.com](mailto:coastalgaslink@tcenergy.com) or by phone to 1-855-633-2011.